

**GENERAL NOTES**

DO NOT SCALE FROM DRAWINGS. WORK TO FIGURED DIMENSIONS ONLY. ARCHITECT TO BE NOTIFIED OF ANY DISCREPANCIES.

THIS DRAWING TO BE READ IN CONJUNCTION WITH ALL ARCHITECT'S DRAWINGS, SPECIFICATIONS CONSULTANTS DESIGN TEAM DRAWINGS AND SPECIFICATIONS.

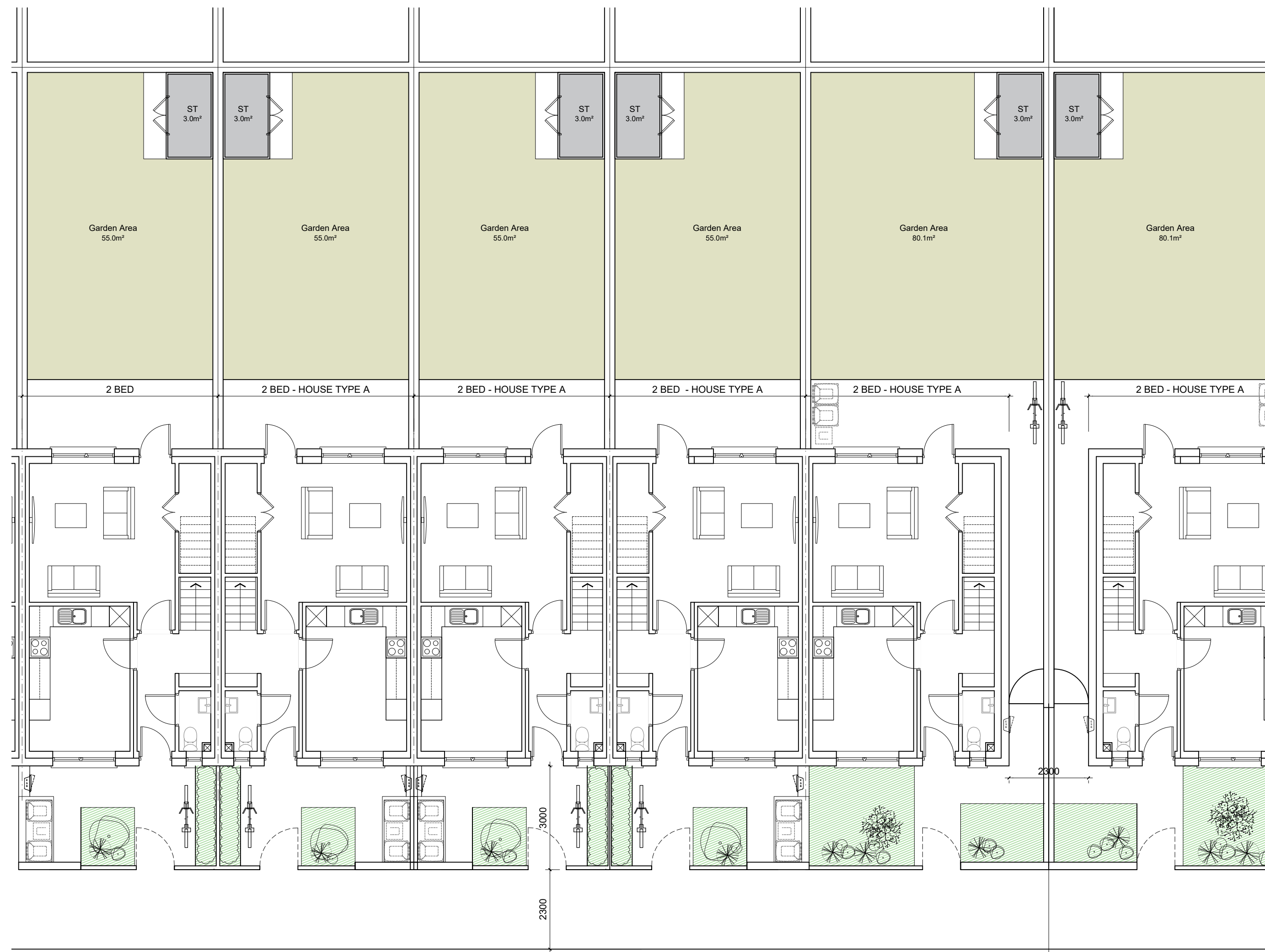

Typical Curtilage Detail - Refer to Key Plan

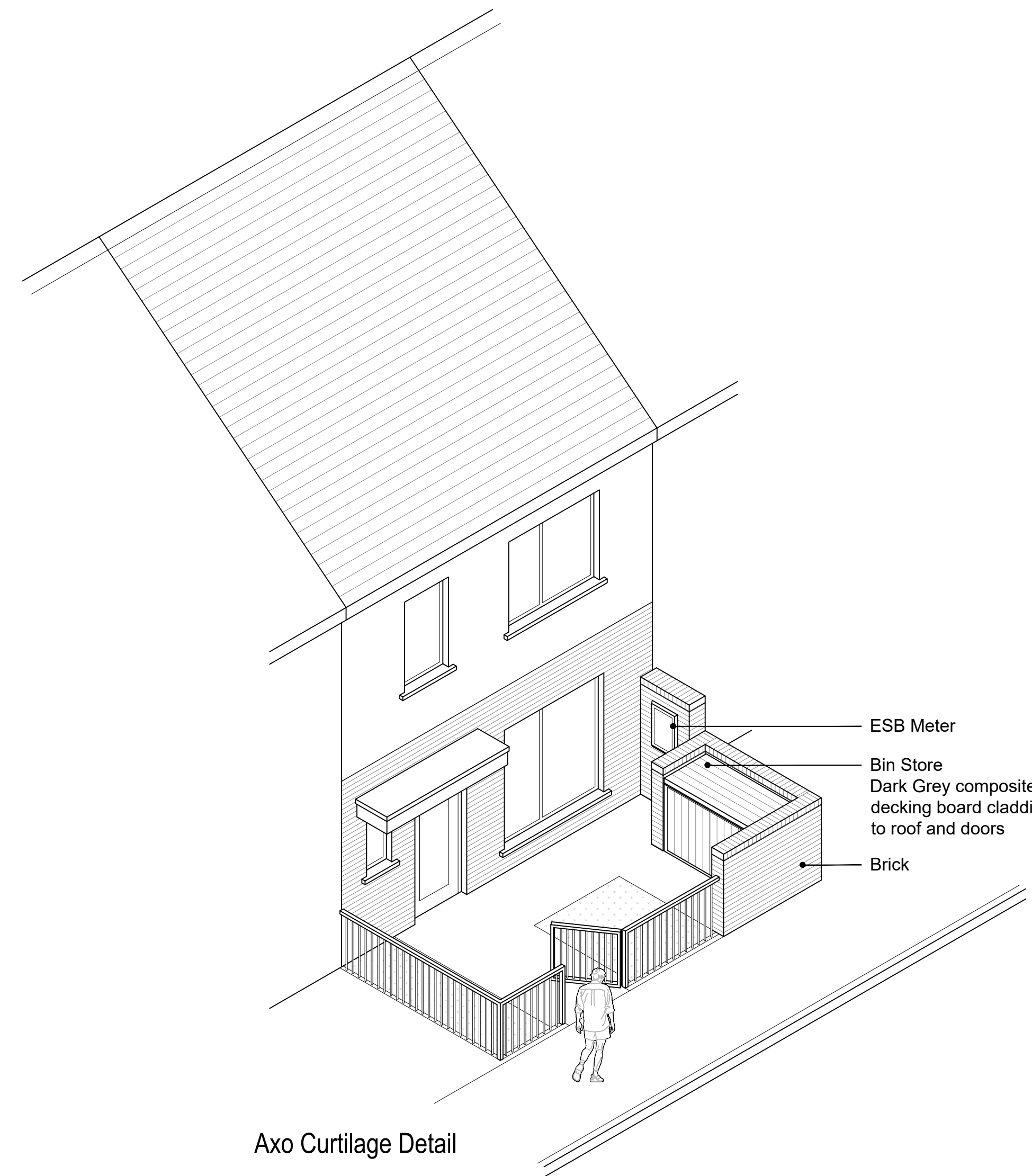

Axo Curtilage Detail



KEY PLAN



Image of typical curtilage treatment to 2-bed House Type A



Image of typical curtilage treatment to 2-bed House Type A

REV	DATE	DESCRIPTION	Issued by
REVISIONS			

**FOR PLANNING**

CLIENT: NDFA on behalf of Kildare County Council

PROJECT TITLE: SHB 4&5

DRAWING TITLE: Typical Curtilage Detail Sheet 2

DRN BY: PD	CHK BY: DL	SCALE @ A1: 1:100	DATE: 11/03/24	REVISION:	JOB NO: 23004
DRAWING NUMBER: SHB5-OCK-DR-MCO-AR-P3-PL202				STATUS CODE: P3	

**M'CORM**  
ARCHITECTURE AND URBAN DESIGN

No. 1 Grantham Street, Dublin 8  
D08 A69Y Tel: +353 (0)1 478 8700  
Block 6, Central Business Park  
Tullamore, County Offaly  
R35 F6F8 Tel: +353 (0)57 932 3867  
website: www.mccorm.com  
email: arch@mccorm.com

Figured dimensions only to be used. This drawing is copyright of M'CORM LTD. All information is shared as per approved use in accordance with I.S. 884:2021 to I.S. EN ISO 19650-2: 2018. If Status Code above is empty, this information has been shared as Status Code SD - Work in Progress (WIP) / Draft.